

## **AGENDA**

### **Gig Harbor Arts Commission Meeting**

Wednesday, September 11, 2024 at 10:00 a.m.

Planning Conference Room or via Zoom

Zoom Link: <https://us06web.zoom.us/j/97936452399>

Call-in: (253) 215-8782 Meeting ID: 979 3645 2399

#### **Call to Order / Roll Call**

**Approval of Minutes:** Minutes of August 14, 2024

#### **Discussion Items:**

- 1) Harborview/Stinson Sidewalk Art Installation Update – Associate Engineer Chloe Wiser
- 2) Love Locks Proposal – Commissioner Killilea
- 3) 2025-26 Work Plan and Budget

#### **Commissioner Reports & Comments**

#### **Public Comment**

#### **Adjourn**



**Gig Harbor Arts Commission  
Call for Art Proposals  
Sidewalk Art Element of the  
Harborview/Stinson Intersection Improvement Project**

The Gig Harbor Arts Commission announces an opportunity for an artist or artists to create and install one or more art pieces in the sidewalk on Harborview Drive at its intersection with Stinson Street in downtown Gig Harbor.

Background: The City of Gig Harbor is installing a traffic round-about at the intersection and as part of the project, a section of sidewalk along Harborview will be replaced, and landscaping will be added nearby. This project is scheduled for completion in the summer of 2022. The art installation is anticipated for fall of 2022.

**Deadline to apply:** Proposals must be received by September 7, 2022

**Project budget:** Not to exceed \$25,000

**Project description:** Design, construct and install sidewalk artwork at the intersection of Harborview and Stinson Streets on the historic Gig Harbor waterfront

**Review and selection:** September 14, 2022

**Award notification date:** September 2022

**Installation:** Fall 2022

**Eligibility:** This project is open to professional artists 18 years of age and older living in Pierce, Kitsap, Mason, King, Thurston, Clallam and Jefferson Counties.

**Submission Process:** Eligible artists interested in this opportunity must submit the following items via email to [cityclerk@gigharborwa.gov](mailto:cityclerk@gigharborwa.gov) no later than September 7, 2022.

## Project Description

The City of Gig Harbor recently installed a traffic roundabout at the intersection of Harborview Drive and Stinson Street on the historic downtown waterfront. A section of sidewalk along Harborview near the roundabout has been designated as a “canvas” for artwork. See Attachment A for a project rendering.

**Site Description / Project Location:** The site is in a residential / business area on the downtown waterfront. Nearby landmarks include the historic Eddon BoatShop and a small city park. (See Exhibit A)

**Design scope:** The Arts Commission is looking for a range of design concepts with emphasis on the fauna and flora of the local marine environment.

- The artwork will create excitement and interest for the community and visiting tourists; create a sense of place and educate the public about the creatures found in the local marine environment.
- The artwork will be of appropriate scale, form, material, content and style.
- Materials must be durable and resistant to pedestrian traffic, with minimum upkeep and maintenance requirements and maximum resistance to deterioration and vandalism.
- The artwork must be ADA compliant; i.e. a smooth surface is required.
- The design must be unique and the original work of the artist.
- The design must not be replicated elsewhere and must be free and clear of any liens or copyrights.
- Works in a variety of media and form will be considered. Examples include, but are not limited to metal, glass, stone, brick, stained concrete.

### Evaluation Criteria:

Artist proposals will be evaluated according to:

- **Theme** – Reference the marine environment of the Harbor
- **Quality** – High artistic quality (demonstrated by previous work)
- **Creativity** – Originality as it relates to the project site and goals
- **Experience** – Ability and experience creating site-specific work with projects of similar scope and scale; demonstrated ability to communicate the proposed concept and to successfully undertake and execute the project in accordance with the scope, budget, and timeline.

**Assumptions:** The following assumptions are being made:

After a proposal has been selected by the Gig Harbor Arts Commission and approved by the Gig Harbor City Council, the Arts Commission reserves the right to negotiate contract details with the artist. If negotiations fail for any reason, the Arts Commission may choose to negotiate with others to obtain an appropriate contract for needed services. The Arts Commission is free to reject all proposals and not make a recommendation to the City Council. In the event that the scope of work changes, the

Arts Commission and the Proposer may negotiate change orders detailing the revised scope of work prior to beginning work on changes.

### **Examples of marine fauna and flora found in Gig Harbor Bay**

- Kelp crabs
- Graceful crabs
- Red rock crabs
- Shore crabs
- Ochre sea stars
- Sunflower stars
- Blood stars
- White Plumed Anemones
- California Sea Cucumbers
- Nudibranchs
- Pricklebacks
- Sculpin
- Midshipman
- Gunnel
- Blue Mussel
- Barnacles
- Feather Duster Tube worms
- Red octopus

**Sidewalk art requirements — per Gig Harbor Public Works Department:** All proposed surfaces shall be flush at both ends with the existing sidewalk and meet all ADA requirements. All proposed surfaces shall be slip resistant.

From the PROWAG (Public Rights-of-Way Accessibility Guidelines):

#### **R302.7.1 Vertical Alignment**

Vertical alignment shall be generally planar within pedestrian access routes (including curb ramp runs, blended transitions, turning spaces, and gutter areas within pedestrian access routes) and surfaces at other elements and spaces required to comply with R302.7 that connect to pedestrian access routes. Grade breaks shall be flush. Where pedestrian access routes cross rails at grade, the pedestrian access route surface shall be level and flush with the top of rail at the outer edges of the rails, and the surface between the rails shall be aligned with the top of rail.

**Advisory R302.7.1 Vertical Alignment.** Pedestrian access route surfaces must be generally planar and smooth. Surfaces should be chosen for easy rollability. Surfaces that are heavily textured, rough, or chamfered and paving systems consisting of individual units that cannot be laid in plane will greatly increase rolling resistance and subject pedestrians who use wheelchairs, scooters, and rolling walkers to the stressful and often painful effects of vibration. Such materials should be reserved for borders and decorative accents located outside of or only occasionally crossing the pedestrian

access route. Surfaces should be designed, constructed, and maintained according to appropriate industry standards, specifications, and recommendations for best practice.

**R302.7.2 Vertical Surface Discontinuities**

Vertical surface discontinuities shall be 13 mm (0.5 in) maximum. Vertical surface discontinuities between 6.4 mm (0.25 in) and 13 mm (0.5 in) shall be beveled with a slope not steeper than 50 percent. The bevel shall be applied across the entire vertical surface discontinuity.

Figure R302.7.2 Vertical Surface Discontinuities

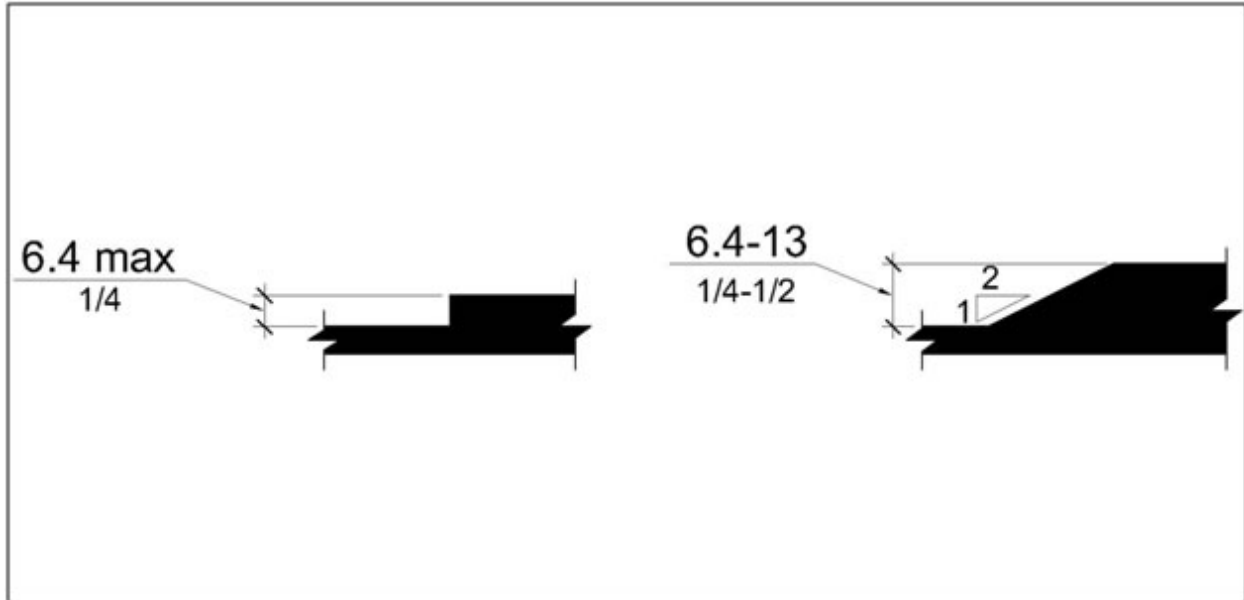

**A complete proposal will include the following:**

- **Short written responses to the following questions in 300 words or less each:**
  1. Why are you interested in this project?
  2. How do you create a public art piece that is responsive or relevant to community?
  3. Anything else you'd like us to know?
  
- **Resume:** Two pages or less. Artist teams should submit a resume for each artist. Include education and experience.
  
- **Work Samples:** Six to eight digital images of past work with concise descriptions, including title, date, materials used, size(s) and any other relevant information. Artist teams are encouraged to submit work that was previously completed as a team.
  
- **References:** Please provide three references including name of contact/client, email address and phone number.
  
- **Artistic Concept:** Please provide a specific concept/design for this project with detailed description of the materials, construction and installation of the components. Include your budget to complete the project. If your concept is selected, you will also be asked to provide a maintenance plan.
  
- **Budget:** Budget must not exceed \$25,000. This total includes City of Gig Harbor permitting, sales tax, travel and installation fees.

# Site Plan



SEC. 5, T 22 N, R 2 E, W.M.

- CONSTRUCTION NOTES:**
- 1 CONSTRUCT CEMENT CONCRETE PATHWAY, PER CITY OF GIG HARBOR DETAIL NO. 2-18 AND 2-19.
  - 2 CONSTRUCT PEDESTRIAN HANDRAIL, PER

- GENERAL NOTES:**
- 1. HATCHING FOR ROW EASEMENTS NOT SHOWN FOR CLARITY, SEE RIGHT OF WAY PLANS.
  - 2. SEE DEMO PLANS FOR EXISTING UTILITIES.
  - 3. SEE SHEET GE-1 FOR LEGEND AND ABBREVIATIONS.

- LEGEND:**
- CEMENT CONCRETE SIDEWALK / PATHWAY
  - REPAIR LANDSCAPE AREAS DAMAGED DURING CONSTRUCTION

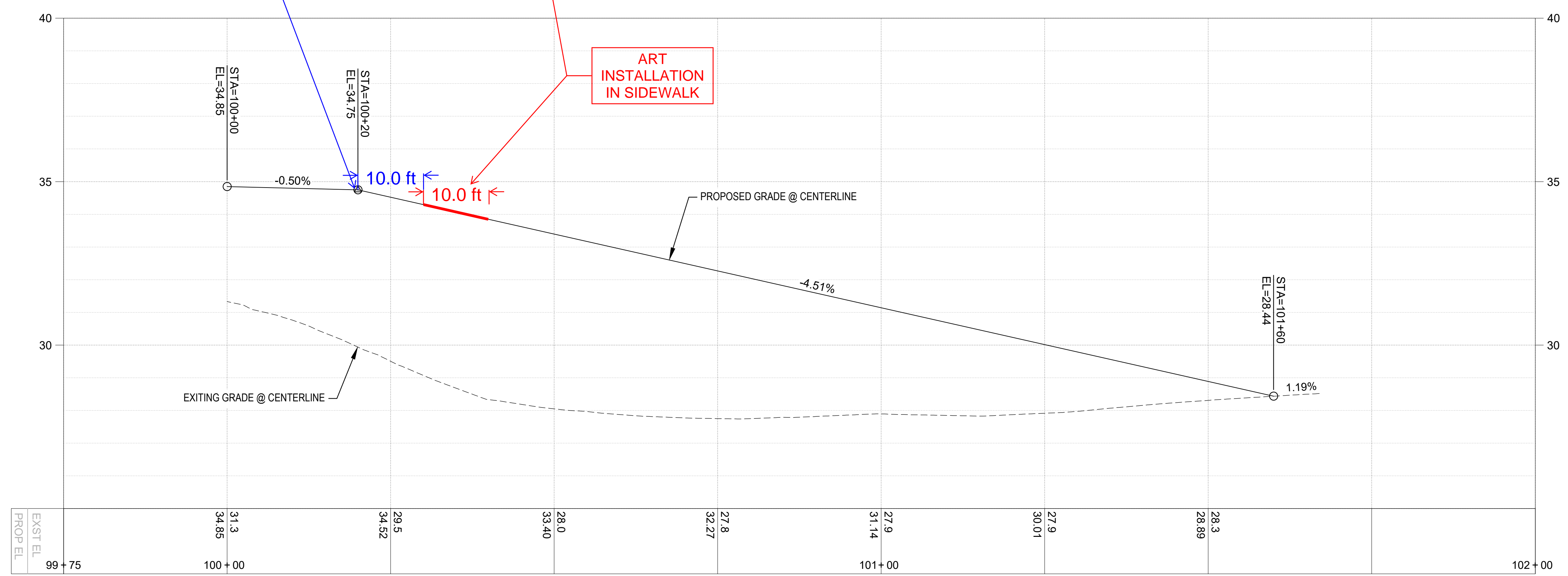
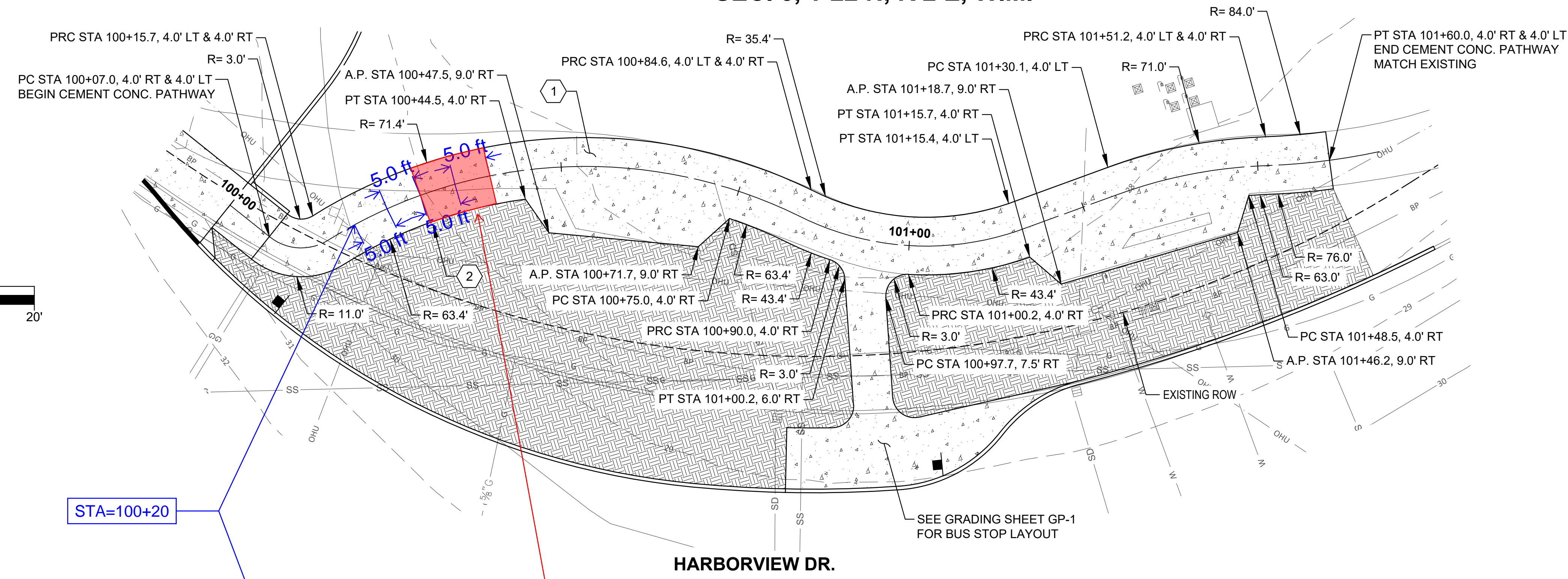
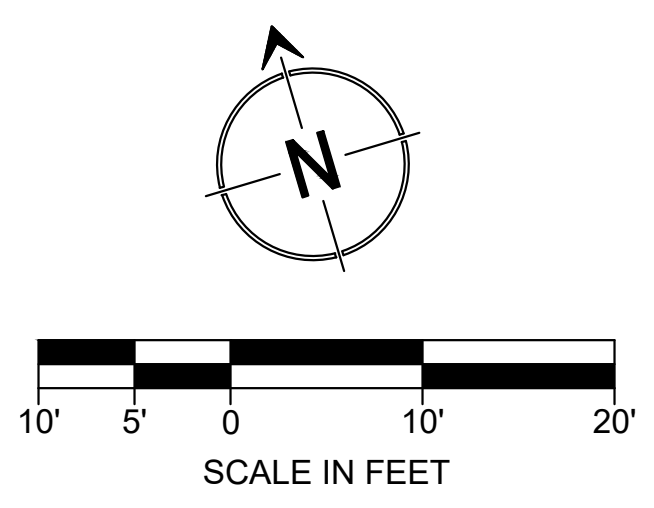

**PATHWAY PROFILE**

SCALE: H 1"=10'  
V 1"=2'

G:\Dropbox (TSS)\TSS\Projects\2020\220006 Harborview Dr & Stinson Ave Intersection Improvement Phase 2\CAD\PS&E\220006-PW.dwg, 01/02/21 08:36:34am

NO.	DATE	REVISION	BY	APPROVED



DESIGNED BY: DH / MM  
 DRAWN BY: MS  
 CHECKED BY: KH  
 APPROVED BY: VS  
 SCALE: AS SHOWN  
 OTHER:

**HARBORVIEW DRIVE  
 STINSON AVENUE  
 INTERSECTION IMPROVEMENTS**

90% SUBMITTAL

PERMIT NO. CSP-1904

DRAWING NO. PW-1

SHEET 7 OF 40

PATHWAY PLAN AND PROFILE



Judith & Daniel Caldwell  
10780 Myers Way South Seattle, WA 98168  
Studio (206) 243-5660, mobile (206) 919-2996  
E-mail: [caldwellhotmetal@comcast.net](mailto:caldwellhotmetal@comcast.net)  
website: [www.caldwellsculpturestudio.com](http://www.caldwellsculpturestudio.com)

## **Concept**

Our proposal for a design approach to the sidewalk art project draws inspiration from vintage nautical charts. In an earlier era, these charts included highly decorative compass roses, along with images of ships sailing across the water, sea monsters and other exotic flora and fauna, and featuring intricate patterning and detail. The 8' x 10' rectangle set aside for the artwork translates logically to a map or chart-like format, anchored by a compass rose surrounded by images of sea creatures and several historic sailing vessels related to Pacific Northwest history.

We are well aware that Gig Harbor already possesses a public artwork that serves as a compass rose: "Fish Flurry" by George and Lavonne Hoivik, from 2002, in front of the Civic Center. Our proposal is for a more traditional compass rose design that incorporates a map of Gig Harbor in the center, and lots of space for marine life.

## **Materials**

All of the embedded elements of the design would be cast or fabricated from Everdur silicon bronze, (CA873) embedded in poured concrete. Anchoring devices for the bronze castings will be either silicon bronze or stainless steel threaded rod (type 304). Depending on the wishes of the committee, we may choose to employ concrete that has integral color, and/or that is stained or dyed.

## **Construction**

All components will be created start to finish in our sandcasting foundry and metal finishing shop.

## **Installation**

The installation method will depend on the final design. We have extensive experience adding artwork to the ground plane, having placed over 1500 bronze castings in more than 20 different projects, using wet-set, core drilling and bock-outs.

## **Budget**

A detailed budget at this phase of planning would not result in an accurate accounting of costs, and becomes a time consuming exercise with little real point. We don't know the cost of applicable city permits, and have not researched current concrete placement costs. But we have thirty years of experience adapting our designs to budgets of all sizes, and are confident that we can meet expectations for the size and complexity of our proposed design, as illustrated in the enclosed drawings, with the funds available. If we are selected we will of course provide a detailed budget listing the cost per bronze casting, and all other expenses associated with the work.

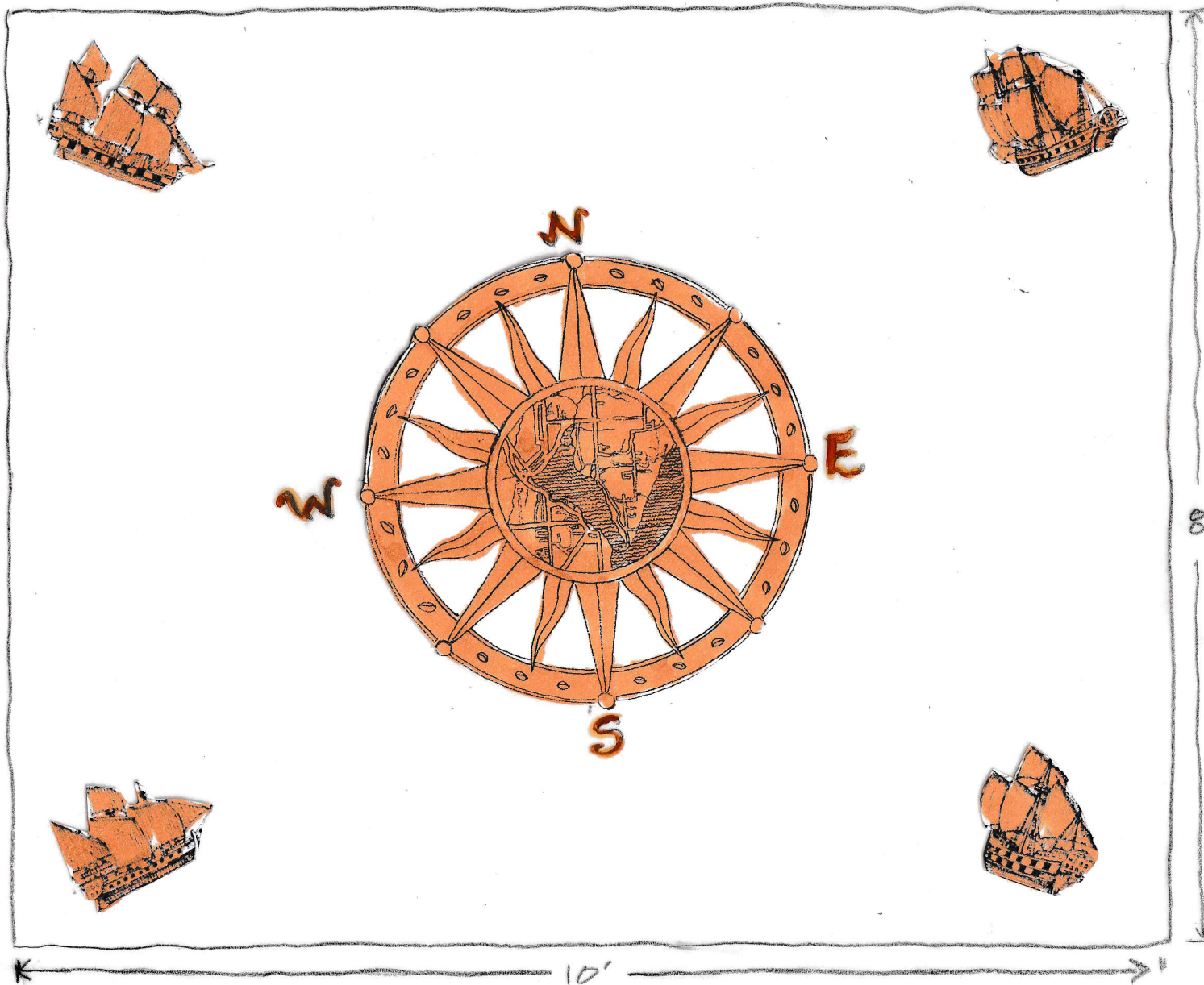

3/4" = 1'

**GIG HARBOR SIDEWALK ART  
PROJECT PRELIMINARY  
DESIGN SCHEMATIC**

Cast bronze Sea Creatures will be studded throughout the white portion of the 'map' which represents the concrete background. The final number of the sea creatures will depend on how much of the budget is left after the elements at left are made and the concrete and permit costs are covered, but we estimate that 2 to 3 of each requested example of marine flora and fauna—depending on size—could be represented, based on a preliminary estimate of costs. We would also install a small plaque that would say "not to scale" since some of the larger critters may be a little smaller than life size, and the tiny ones will be much larger than life size, which is consistent with the distortion of relative scale on the antique maps that we are referencing in this design. (We haven't drawn the critters into this schematic since this is not a final design, and their placement can easily be described.)

This drawing addresses the 8' x 10' area of the sidewalk set aside for a pavement art project. The center of the Compass Rose depicts a map of the Gig Harbor waterway with features of the surrounding land, which would, of course, be much more detailed in the full scale version. We have approximated North on this drawing, but it's probably a little off. The ships in each corner would be representations of historic vessels that sailed in Puget Sound during the years of its discovery and exploration by Europeans. They could be replaced by animals, if desired; an octopus in each corner, for example, would be splendid. We consider this design a start to the discussion that will result in modifications and improvements based on response from the interested members of the community or committee. All of the colored elements in the drawing above will be cast bronze.

**GIG HARBOR SIDEWALK ART  
COMPASS ROSE DRAWING**



**This drawing shows the 48" diameter center portion of the Compass Rose depicted in the sidewalk illustration, with a larger center ring and some added texture and detail. The map, sun rays, and inner and outer rings are cast bronze, with concrete between the sun rays and the inner and outer rings. The directional indicators dividing the outer ring are mussels. The N-S-E-W indicators are outside of this circle.**

## LIST OF CANDIDATES FOR BRONZE MEDALLIONS

25 critters are listed here, but a few more will be identified with further research.. These will not, in most cases, be actual size, but will be sized to relate to the diameter of the medallions, with smaller animals on the smaller disks and larger animals on the larger disks. There will also be a small bronze disk that states: *NOT ACTUAL SIZE*.

Kelp crabs: shell	up to 4.3 inches wide
Graceful crabs:	shell up to 4.5 inches wide
Red rock crabs:	shell up to 7.8 inches wide
Shore crabs	shell up to 2.2 inches wide
Ochre sea stars:	up to 24 inches across
Sunflower stars:	to 39 inches across
Blood stars: up to	6.3 inches across
White Plumed Anemones:	usually under 20" tall
(Also second view of White Plumed Anemone from above)	
California Sea Cucumbers:	up to 18"
3 Nudibranchs*	
opalescent nudibranch	up to 2"
striped nudibranch	up to 3.14 inches
yellow margin nudibranch	up to 3"
3 Pricklebacks*	
High Cockscomb	4" to 5"
Mosshead Warbonnet	4" - 6"
Rock Prickleback	up to 22"
Sculpin*	2" to 30" depending on species
Midshipman (Plainfin)	up to 15"
2 Gunnels*	
Crescent Gunnel	up to 10"
Saddleback Gunnel	up to 12"
Blue Mussel	2-4"; up to 8"
2 Barnacles	
Gooseneck	up to 8"
Giant Acorn	up to 6" x 12"
Feather Duster Tube worm	worm up to 10"; tube to 17"
Red octopus:	4" mantle, 16" arm

\* more research is needed to determine which species are most likely to be found in Gig Harbor